

INSTRUCTIONS FOR CAPSULES^

1 ISOLATE TOOTH, PREPARE CAVITY.
Apply Riva Conditioner for 10 seconds

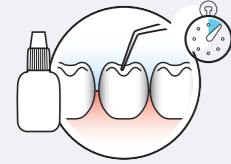

2 Wash thoroughly.

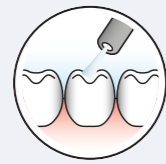

3 Remove excess water.
Keep moist.



4 Activate the capsule and immediately mix in a triturator.
IMPORTANT DO NOT CLICK WITH APPLICATOR BEFORE YOU MIX

Press capsule down to click.

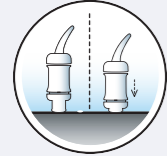

Ten seconds in a triturator.



5 Immediately place into a capsule applicator and click trigger until paste is seen through the nozzle.

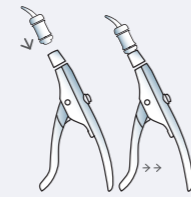

6 Extrude Riva Light Cure in increments of no more than 2mm into cavity.

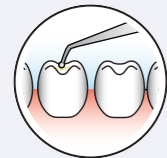

7 Light cure each increment for 20 seconds



8 Final finishing under water spray can begin immediately after light curing

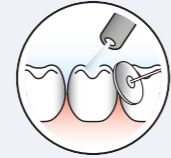

ORDER DETAILS



CAPSULES

Riva Light Cure Capsules
50 Riva Light Cure capsules

A1	8700001
A2	8700002
A3	8700003
A3.5	8700004
A4	8700005
B2	8700007
B3	8700008
B4	8700010
C2	8700012
C4	8700014
Bleach	8700016

Riva Light Cure Capsule Assorted Kit
10 each of A1, A2, A3, A3.5 and B2 capsules

8710000

Riva Light Cure HV Capsules
50 Riva Light Cure HV capsules

A1	8730001
A2	8730002
A3	8730003
A3.5	8730004
B1	8730006



POWDER AND LIQUID

Riva Light Cure Powder / Liquid Kits
8g (7.2mL) Riva Light Cure Liquid bottle
15g Riva Light Cure Powder bottle
Accessories

A1	8700501
A2	8700502
A3	8700503
A3.5	8700504
A4	8700505
B2	8700507
B3	8700508
C2	8700512
C4	8700514
Bleach	8700516

Riva Light Cure Powder / Liquid Kits
3g (2.7mL) Riva Light Cure Liquid bottle
5g Riva Light Cure Powder bottle
accessories

A2	8700517
A3	8700518

Riva Light Cure Liquid Refill
8g (7.2mL) Riva Light Cure Liquid bottle

8700900

Riva Light Cure Powder Refills
15g Riva Light Cure Powder refill

A1	8700101
A2	8700102
A3	8700103
A3.5	8700104
B2	8700107



APPLICATORS

Riva Applicator	5545009
Riva Applicator 2	5545013
Riva Applicator 2 Black	5545023



ACCESSORIES

Riva Coat 5mL bottle refill	8610001
Riva Conditioner 10mL bottle refill	8620001

* Fuji II LC and Photac Fil Quick are not the registered trademarks of SDI Limited.

** Published and SDI Test Data.

[1] C. Decoteau, M. Ogledzki, R.D. Perry and G. Kugel; Translucency of Resin Modified Glass Ionomer Restoratives: Tampa AADR, March 2012, Tufts University, Boston, MA, USA.

[2] Duong T, Tran L, Perry R, Kugel G [2007]. Microleakage testing in vitro using three different bases under composites. Special Issue of the Journal of Dental Research. Tufts University, Boston, MA, USA.

[3] McCabe JF, Al-Naimi OT. Fluoride release of three Riva GI Products Compared with that of a competitor product. University of Newcastle (UK); August 2006.

[4] Al-Naimi OT, Lopes MB, McCabe JF, Prentice LH. Flexural Strength of Resin-Modified Glass-Ionomer cements (RMGICs). Brisbane (Australia); June 2006.

SDI | YOUR SMILE. OUR VISION.

MADE IN AUSTRALIA
by SDI Limited
Bayswater, Victoria 3153
Australia 1 800 337 003
www.sdi.com.au

AUSTRIA 00800 0225 5734
BRAZIL 0800 770 1735
FRANCE 00800 0225 5734
GERMANY 0800 100 5759
ITALY 00800 0225 5734

NEW ZEALAND 0800 734 034
SPAIN 00800 0225 5734
UNITED KINGDOM 00800 0225 5734
USA & CANADA 1 800 228 5166



07-2019

M870001.J



003808700011

SDI | RIVA LIGHT CURE

LIGHT CURED RESIN REINFORCED
GLASS IONOMER RESTORATIVE MATERIAL



^ For powder and liquid instructions, please refer to Instructions for Use

THE GLASS IONOMER RESTORATIVE WITH TRUE AESTHETICS

COMBINATION OF GIC ADVANTAGES AND COMPOSITE ADVANTAGES

Riva Light Cure is a light-cured, resin-reinforced glass ionomer restorative cement. Glass ionomers release fluoride and chemically bond to the tooth structure whilst composites have excellent aesthetics. Riva Light Cure is a combination of both with excellent aesthetics, fluoride release and it chemically bonds to the tooth structure.

Riva Light Cure utilises SDI's proprietary *ionglass™* filler developed by our glass technologists. *ionglass™* is a radiopaque, high ion releasing, bioactive glass used in SDI's range of glass ionomer products. Riva Light Cure releases fluoride to assist with remineralisation of the natural dentition.



11
SHADES

COLOUR STABILITY

HIGHEST COLOUR STABILITY

Riva Light Cure has excellent resistance to common stains such as black tea and red wine. Riva Light Cure absorbs about half as much color from these tannin-rich solutions.

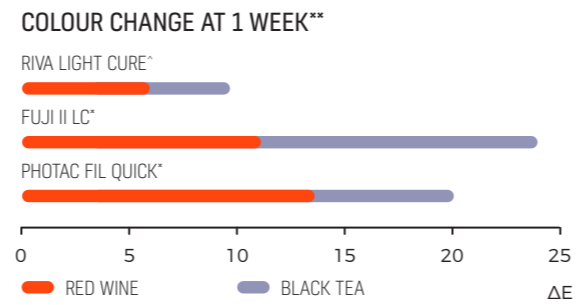

LONG TERM WEAR RESISTANCE

The surface hardness of resin-reinforced glass ionomer cements means good long-term wear resistance. The greater the surface hardness, the greater the resistance to permanent surface indentation.

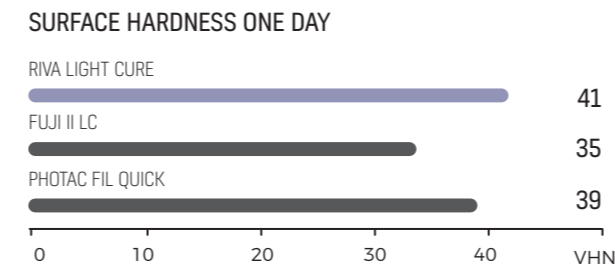

GREAT MARGINAL ADAPTATION

Riva Light Cure is the answer to long term microleakage prevention. Use it as a restorative or a base under permanent restorations. "...light-cured and self-cured glass ionomer bases were more effective in reducing microleakage in both the occlusal and proximal cavo surfaces than a flowable resin."⁽²⁾

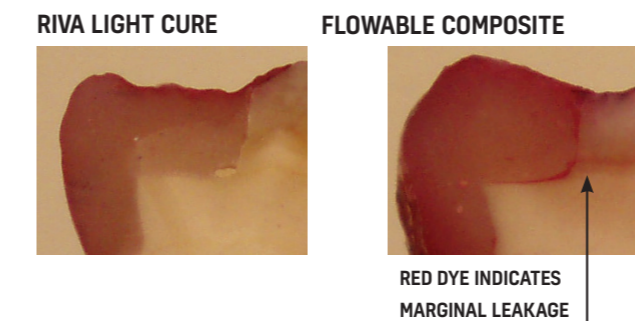

BPA FREE

NON-STICK HANDLING

Riva Light Cure HV can be manipulated immediately after mixing. It is a very sculptable material. It does not stick to instruments and resists any initial threading traditionally found with a light cured GIC. Riva Light Cure HV does not lift off after placement, particularly in the maxillary position.

ORANGE LIGHT SAFE TIP

Riva Light Cure's capsule has a transparent orange nozzle. This protects the paste from curing under operating light in between placement.

SIMPLE PROCEDURE

Riva Light Cure is quick and simple to place. No bonding procedure is required. It chemically bonds to the tooth and provides ion exchange to demineralised dentition.

FABULOUS AESTHETICS

FABULOUS AESTHETICS

Riva Light Cure's translucency ensures aesthetics are maximised to enable natural looking restorations with chameleon effects. "Riva Light Cure is the most translucent of the RMGIs tested"⁽¹⁾

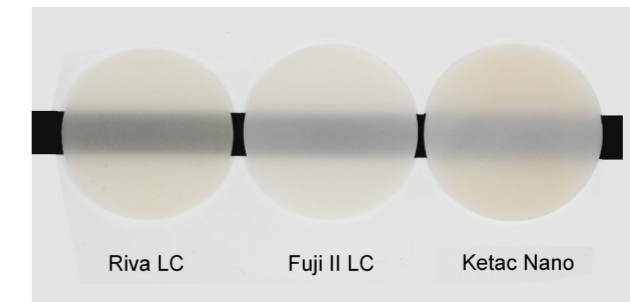

TRANSLUCENCY COMPARISON

Riva Light Cure is an ideal enamel replacement. Riva Light Cure is available in 11 shades: A1, A2, A3, A3.5, A4, B2, B3, B4, C2, C4 and bleach. Riva Light Cure enables natural looking restorations with chameleon effects.



PHOTOS COURTESY OF DR ARA NAZARIAN, MICHIGAN, USA



PHOTOS COURTESY OF DR GEOFF KNIGHT, VICTORIA, AUSTRALIA

ADVANTAGES

- Chemically adheres to tooth structure
- Orange light safe tip prevents premature setting
- BPA free
- Highest colour stability to tea & coffee
- Fabulous aesthetics
- Excellent marginal integrity
- Long term wear resistance due to high surface hardness
- High flexural strengths
- Flexible working time
- Great for minimally invasive dentistry (MID)
- High fluoride releasing and recharging ability
- Bioactive proprietary *ionglass™* technology - high ion exchange
- Varnishing not required
- Radiopaque



INDICATIONS

	Riva Light Cure	Riva Light Cure HV
Non stress bearing Class I and II restorations	●	●
Class III restorations	●	●
Cervical (Class V) restorations		
- Cervical erosions	●	●
- Abfraction lesions	●	●
- Root surface restorations	●	●
Deciduous teeth restorations	●	●
Geriatric restorations	●	●
Core build ups	●	●
Pit and fissure sealing	●	●
Temporary fillings	●	●
Liner	●	●
Base / dentin replacement	●	●
Co-curing with composite (Sandwich technique)	●	●

HIGH FLEXURAL STRENGTH

High flexural strength ensures reduced cracking and failure in flexion. Riva Light Cure has excellent flexural strength.

